

HD Multisensor Dome Cameras

Avigilon offers a broad range of high definition cameras – from 1 – 5 MP and 4 – 7K (based on horizontal resolution) – and are available in a variety of formats, including dome, panoramic and fixed. Whether it's a small storefront that requires a few cameras or a large complex system requiring complete coverage of numerous areas, you can trust that you're getting an exceptional solution for your security needs.

The innovative HD Multisensor dome camera is just one way Avigilon can help provide the very best monitoring and protection.



Avigilon's HD Multisensor dome camera offers unsurpassed image quality and flexibility with multi-directional scene coverage. Available in 3 (9 MP) or 4 (12 MP) sensor configurations, each equipped with a remote zoom and focus lens, one HD Multisensor dome can replace a PTZ or multiple fixed cameras, requiring just a single installation with one ethernet cable and one camera license. Avigilon's innovative camera track design allows three or four individual camera gimbals to be individually positioned in flexible configurations to meet challenging field of view requirements. Available in 3 easy to install configurations; in-ceiling, and IP66 and IK10 rated surface mount and outdoor pendant, the HD Multisensor dome camera is ready for all environments.

KEY FEATURES

3 x 3 MP (9 MP) or 4 x 3 MP (12 MP) 1/3" Progressive scan sensor
Each lens is a 3 MP 2.8-8mm remote zoom and focus lens
H.264 and Motion JPEG compression
100dB Wide Dynamic Range performance
ONVIF compliant API
Automatic exposure control and iris control
Automatic removable IR cut filter for IR sensitivity at night
Power over Ethernet, 24 VAC or 24 VDC power input
External microphone and speaker support for two-way audio
External I/O interface for connecting alarms and relays
Supports broad environmental conditions for challenging outdoor installations

Specifications

SPECIFICATIONS		IN-CEILING MOUNT (H3-MH-DC)			SURFACE MOUNT (H3-MH-DO)		PENDANT MOUNT (H3-MH-DP)				
IMAGE PERFORMANCE (per image sensor)	Image Sensor		WDR 1/3" progressive scan CMOS								
	Active Pixels	per image sensor	2048 (H) x 1536 (V)								
		3 x image sensor	6144 (H) x 1536 (V)								
		4 x image sensor	8192 (H) x 1536 (V)								
	Imaging Area		4.5 mm (H) x 3.4 mm (V); 0.189" (H) x 0.106" (V)								
	Minimum Illumination		0.23 lux (F1.3) in color mode; 0.023 lux (F1.3) in monochrome mode								
	Dynamic Range		100 dB								
	Image Rate		3 image sensor model: 20 fps per image sensor 4 image sensor model: 15 fps per image sensor								
Resolution Scaling		Down to 352 x 240									
LENS (per image sensor)	Lens		2.8-8mm, F1.3, P-Iris, remote zoom and focus								
	Angle of View		32.5° - 93°								
IMAGE CONTROL	Image Compression Method		H.264 (MPEG-4 Part 10/AVC), Motion JPEG								
	Streaming		Multi-stream H.264 and Motion JPEG								
	Motion Detection		Selectable sensitivity and threshold								
	Electronic Shutter Control		Automatic, Manual (1/6 to 1/8000 sec)								
	Iris Control		Automatic, Manual								
	Day/Night Control		Automatic, Manual								
	Flicker Control		50 Hz, 60 Hz								
	White Balance		Automatic, Manual								
	Backlight Compensation		Adjustable								
	Privacy Zones		Up to 64 zones								
	Audio Compression Method		G.711 PCM 8 kHz								
	Audio Input/Output		Line level input and output								
	External I/O Terminals		Alarm In, Alarm Out								
	NETWORK	Network		100BASE-TX							
Cabling Type		CAT5									
Connector		RJ-45									
API		ONVIF compliance version 1.02, 2.00, Profile S (www.onvif.org)									
Security		Password protection, HTTPS encryption, digest authentication, WS authentication, user access log, 802.1x port based authentication									
Protocol		IPv6, IPv4, HTTP, HTTPS, SOAP, DNS, NTP, RTSP, RTCP, RTP, TCP,UDP, IGMP, ICMP, DHCP, Zeroconf, ARP,									
Streaming Protocols		RTP/UDP, RTP/UDP multicast, RTP/RTSP/TCP, RTP/RTSP/HTTP/TCP, RTP/RTSP/HTTPS/TCP, HTTP									
Device Management Protocols		SNMP v2c, SNMP v3									
MECHANICAL	Dimensions (ØxH)		232 mm x 223 mm; 9.1" x 8.8"			213 mm x 159 mm; 8.4" x 6.3"			226 mm x 313 mm; 8.9" x 12.3"		
	Weight		2.18 kg (4.85 lbs)			3.3 kg (7.3 lbs)			3.9 kg (8.6 lbs)		
	Dome Bubble		Nylon, clear								
	Body		Plastic			Aluminum			Aluminum		
	Housing		Recessed mount			Surface mount			Pendant mount		
	Finish		Plastic, cool grey			Powder coat, cool grey			Powder coat, cool grey		
	Tilt		+10° to +67° (depending on position of image sensors)								
	Pan		+/-12° to +/-30° (depending on position of image sensors)								
	Azimuth		+/- 180°								
	Onboard Storage		SD/SDHC/SDXC slot – minimum class 4; class 6 or better recommended								
ELECTRICAL	Power Consumption		13 W with external power or IEEE 802.3af Class 3 PoE			26 W with external power or IEEE 802.3at Type 2 PoE Plus 13 W with IEEE 802.3af Class 3 power					
	Power Source		VDC: 24 V +/- 10%, 13 W min VAC: 24 V +/- 10%, 19 VA min PoE: IEEE 802.3af Class 3			VDC: 24 V +/- 10%, 26 W min. VAC: 24 V +/- 10%, 37 VA min. PoE: IEEE 802.3af Class 3 or IEEE 802.3at Type 2			VDC: 24 V +/- 10%, 26 W min. VAC: 24 V +/- 10%, 37 VA min. PoE: IEEE 802.3af Class 3 or IEEE 802.3at Type 2		
	Power Connector		2-pin terminal block			2-pin terminal block			Waterproof 2-pin connector		
	RTC Backup Battery		3V Manganese Lithium			3V Manganese Lithium			3V Manganese Lithium		
ENVIRONMENTAL	Operating Temperature		-10 °C to +50 °C (14 °F to 122 °F)			-40 °C to +50 °C (-40 °F to 122 °F) with external power or IEEE 802.3at Type 2 PoE Plus -20 °C to +50 °C (-4 °F to 122 °F) with IEEE 802.3af Class 3 power					
	Storage Temperature		-10 °C to +70 °C (14 °F to 158 °F)			-10 °C to +70 °C (14 °F to 158 °F)					
	Humidity		0 - 95% non-condensing			0 - 95% non-condensing					
CERTIFICATIONS	Certifications		UL	cUL	CE	ROHS	WEEE	RCM	EAC	KC	
	Safety		UL 60950-1			CSA 60950-1			IEC/EN 60950-1		
	Environmental					IK10 Impact Rating			Meets IP66 Weather Rating		
	Electromagnetic Emissions		IC ICES-003 Class B		FCC Part 15 Subpart B Class B	EN 55032 Class B		EN 61000-6-3		EN 61000-3-2	EN 61000-3-3
	Electromagnetic Immunity		EN 55024			EN 61000-6-1					

Outline Dimensions

In-Ceiling Mount

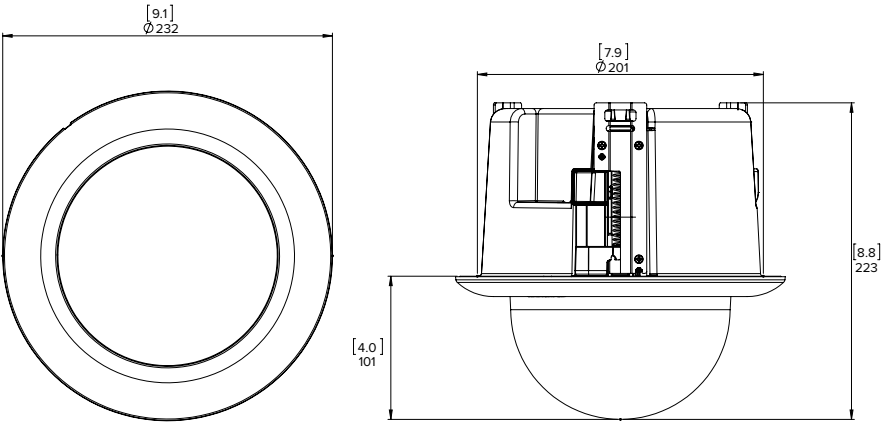

[X.X]	INCHES
X	MM

Surface Mount

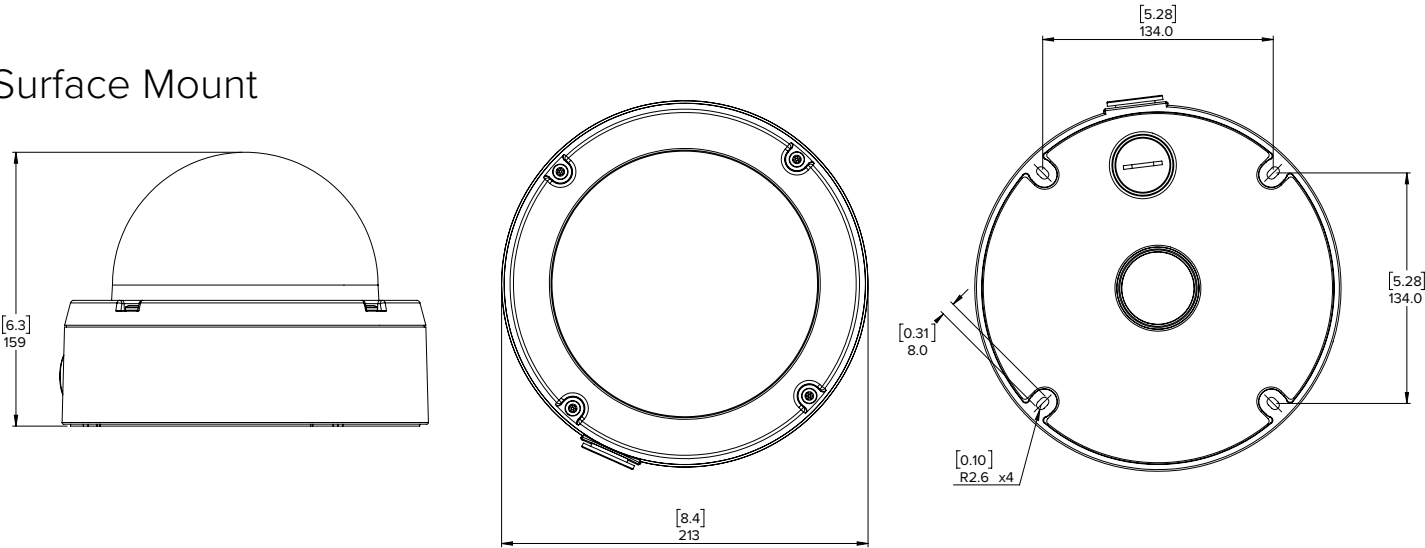

Pendant Mount

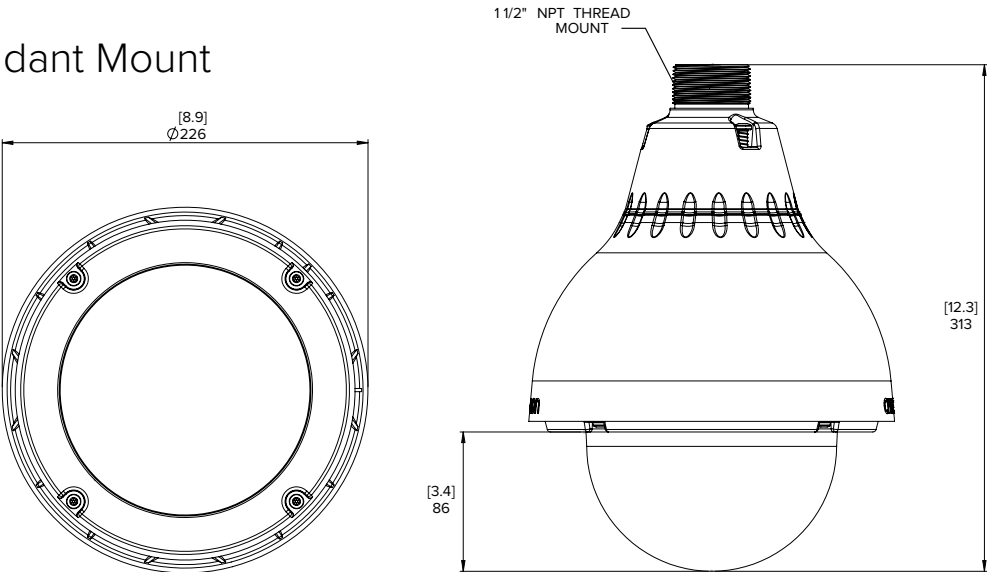

Ordering Information

IN-CEILING MOUNT

9W-H3-3MH-DC1	3 x Image Sensor In-Ceiling HD Multisensor Dome Camera
12W-H3-4MH-DC1	4 x Image Sensor In-Ceiling HD Multisensor Dome Camera
PTZMH-DC-CLER1	PTZ In-Ceiling Dome Camera Cover with Clear Bubble
PTZMH-DC-SMOK1	PTZ In-Ceiling Dome Camera Cover with Smoked Bubble
PTZMH-DC-CPNL1	Metal Ceiling Panel

SURFACE MOUNT

9W-H3-3MH-DO1-B	3 Image Sensor Outdoor HD Multisensor Dome Camera
12W-H3-4MH-DO1-B	4 Image Sensor Outdoor HD Multisensor Dome Camera
PTZMH-DP-CLER1	Dome Camera Cover with Clear Bubble (IK10)
PTZMH-DP-SMOK1	Dome Camera Cover with Smoked Bubble (IK10)

PENDANT MOUNT

9W-H3-3MH-DP1-B	3 Image Sensor Pendant HD Multisensor Dome Camera
12W-H3-4MH-DP1-B	4 Image Sensor Pendant HD Multisensor Dome Camera
CM-MT-WALL1	Pendant wall mount
H4-MT-POLE1	Pole Mounting Bracket
H4-MT-CRNR1	Corner Mounting Bracket
PTZMH-DP-CLER1	Dome Camera Cover with Clear Bubble (IK10)
PTZMH-DP-SMOK1	Dome Camera Cover with Smoked Bubble (IK10)