

# 710r

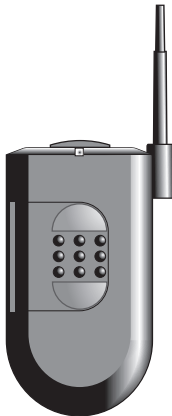

**COOPER** Security

**Scantronic**

1

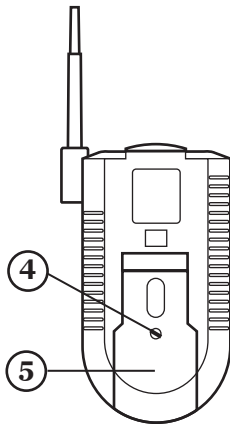
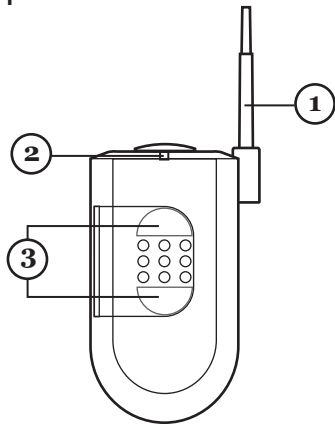

## **En**

1. Aerial
2. Activity LED
3. Push buttons
4. Screw
5. Battery compartment cover

## **NI**

1. Antenne
2. Activiteiten LED
3. Druktoetsen
4. Schroefje
5. Batterijhouder deksel

## **Fr**

1. Antenne
2. LED d'activité
3. Touches
4. Vis
5. Capot du compartiment batterie

## **It**

1. Antenna
2. LED di attività
3. Tasti
4. Vite
5. Coperchio del comparto batterie

2



113mm

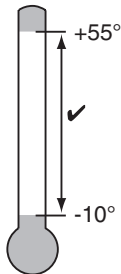
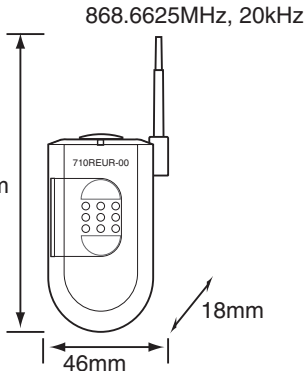

Security: EN510131 Grade 2

Environmental: Class II



3

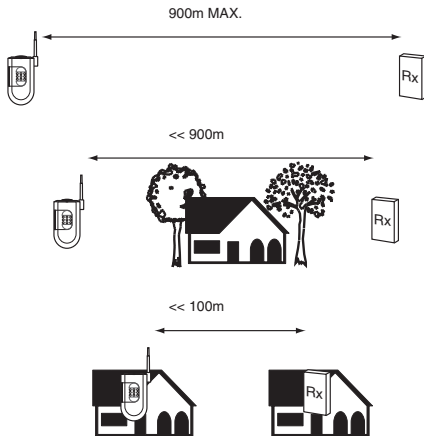

4

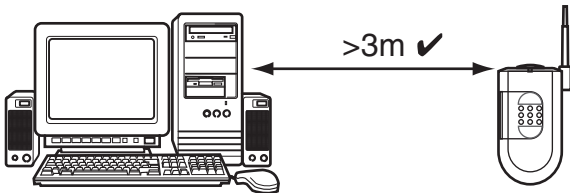
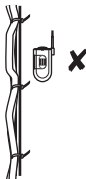
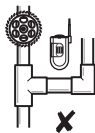

5

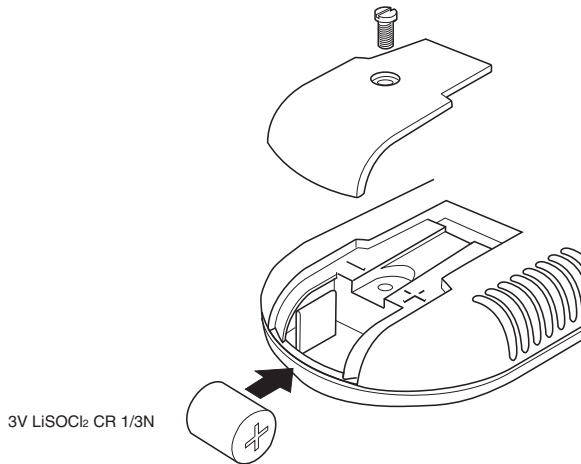

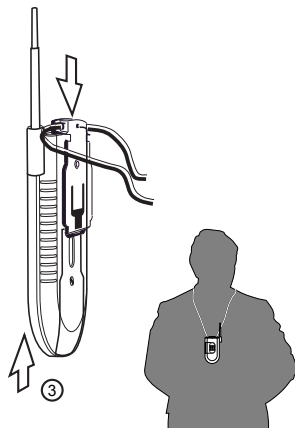
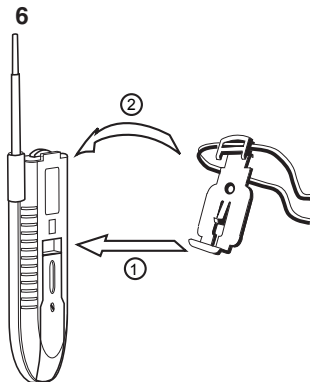



7

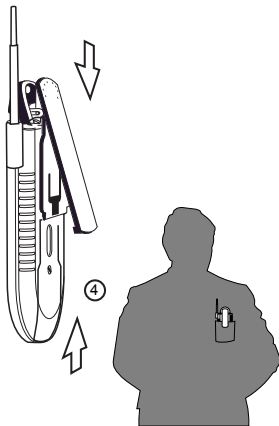
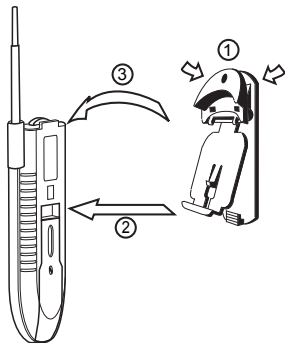

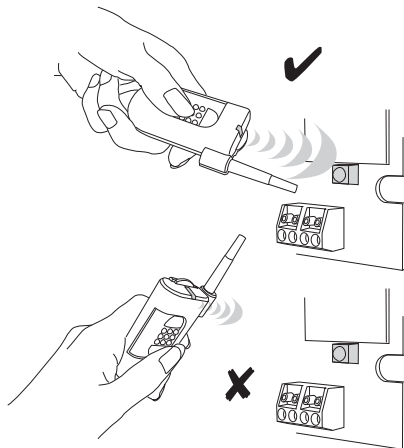

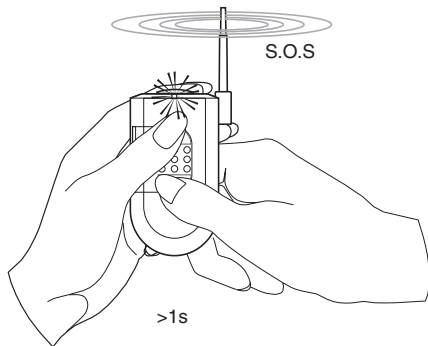

7500 ✓

7510 ✓

9960 ✓

RFX16 ✓

RFX08 ✓

762 ✓

768/769 ✓

EXP-R10/30 ✓

10

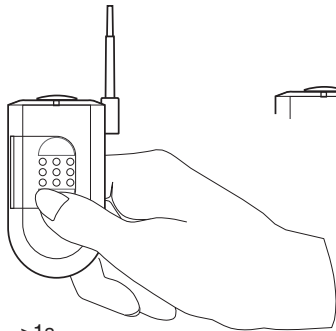

=



=



## **Replacing the Battery**

When the battery is finished, replace it with a fresh 3V LiSOCl<sub>2</sub> CR 1/3N battery. Before inserting the new battery, briefly short together the terminals of the battery holder with a screw driver or short length of wire. This ensures that the processor restarts correctly when you insert the fresh battery.

## **Vervangen van de Batterij**

Wanneer een batterij leeg is moet deze vervangen worden door een nieuwe 3V LiSOCl<sub>2</sub> CR 1/3N batterij. Alvorens de batterij te plaatsen gelieve de batterij aansluitingen middels een schroevendraaier of stukje kabel kort, kort te sluiten. Dit zorgt ervoor dat de processor op de juiste manier opstart wanneer de nieuwe batterij geplaatst wordt.

## **Remplacement de la pile**

Lorsque la pile est faible il faut la remplacer par la référence 3V LiSOCl<sub>2</sub> CR 1/3N. Avant d'insérer la nouvelle pile et lorsque la pile faible a été retirée, court-circuité les deux rupteurs de pile de l'émetteur avec un tournevis afin de l'initialiser.

## **Sostituzione della batteria**

Quando la batteria è scarica, sostituirla con una nuova dello stesso tipo 3V LiSOCl<sub>2</sub> CR 1/3N. Prima di inserire la batteria nuova, eseguire un corto circuito momentaneo ai terminali di batteria sulla scheda del dispositivo utilizzando la punta di un cacciavite o un pezzo di filo elettrico. Questo assicura che il processore esegue il corretto riavvio una volta inserita la batteria nuova.

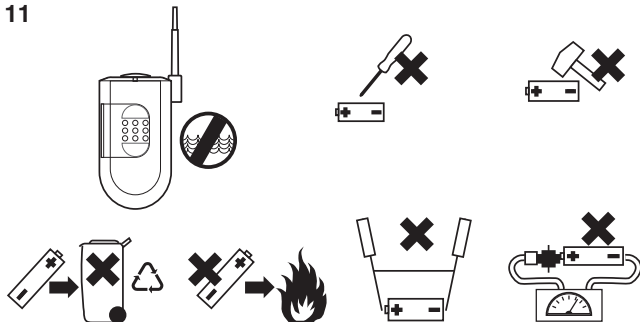

[www.coopersecurity.co.uk](http://www.coopersecurity.co.uk)



This product complies with the requirements of European Directive: **1995/5/EC** (Radio & Telecommunications Terminal Equipment Directive).

Dit product is conform de normen van de Europese Richtlijn 1995/5/EC (R&TTE Richtlijn)

Questo prodotto è conforme ai requisiti della Direttiva Europea: **1995/5/EC** (Radio & Telecommunications Terminal Equipment Directive).

Dette produkt er i overensstemmelse med kravene i EU-direktivet: **1995/5/EF** (Direktiv om radio- og teleterminaludstyr).

Dette produktet overholder kravene i EU-direktivet: **1995/5/EC** (Radio & Telecommunications Terminal Equipment Directive, R&TTE).

Den här produkten uppfyller kraven i EU-direktivet: **1995/5/EG** (direktivet för radioutrustning och teleterminalutrustning).

Dieses Produkt erfüllt die Anforderungen der europäischen Richtlinie **1995/5/EG** (Richtlinie für Funkanlagen und Telekommunikationsendeinrichtungen).

Este producto cumple con los requisitos de la Directiva Europea **1995/5/CE** (Directiva de equipo de terminal de radio y telecomunicaciones).

Este produto está conforme os requisitos da Directiva Europeia: **1995/5/CE** (Directiva sobre Equipamento de Radiocomunicações e Terminal de Telecomunicações).

Tämä tuote täyttää EU:n direktiivin **1995/5/EY** (Radio- ja telepäätelaitedirektiivi) asettamat vaatimukset.

For more information see: [www.coopersecurity.co.uk](http://www.coopersecurity.co.uk).

**UK:** Cooper Security Ltd  
Security House  
Vantage Point Business Village  
Mitcheldean  
Gloucestershire  
GL17 0SZ  
Product Support (UK) Tel: +44 (0)1594 541 978  
Available between:  
08:15 and 17:00 Monday to Friday,  
Product Support Fax: +44 (0)1594 545401  
**Fr:** Cooper Security  
9-11 rue des Raverdis  
92230 GENNEVILLIERS - France  
Tél. : 01.41.11.32.90  
Fax : 01.41.11.32.91

**NL:** Cooper Security Ltd  
Terheydenseweg 465  
4825 BK Breda  
NEDERLAND  
Tel: +31 (0)76 5729944  
Fax: +31 (0)76 5729949  
[www.cooper-security.nl](http://www.cooper-security.nl)  
**It:** Cooper CSA S.r.l.  
Via A. Meucci, 10 - 20094 - Corsico - (MI)  
Tel.: +39 024587911 Fax: +39 0245879105  
[www.coopercsa.it](http://www.coopercsa.it)

© Cooper Security Limited 2013

Every effort has been made to ensure that the contents of this leaflet are correct . However, neither the authors nor Cooper Security Limited accept any liability for loss or damage caused or alleged to be caused directly or indirectly by this leaflet. The contents of this leaflet are subject to change without notice.

Printed and published in the U.K.

Issue2 Part No. 12360201  
[www.coopersecurity.co.uk](http://www.coopersecurity.co.uk)